

Miner's Headlamp with Cord (ALK300)

Product #	Colour	Description
ALK300	Black	Miner's helmet lamp

Primary function

- LED technology
- Extra-long lifespan: 50,000 hours
- Low-battery alert (when the power is not enough for one hour lighting, the lamp will flash once every 6 seconds)
- “Li-ion” battery: compact and lightweight with no maintenance required
- Intelligent charge protection: overcharge protection, current control, short-circuit protection and overheat protection



Features	Specifications
Rated capability	6.5Ah (li-ion battery)
Rated voltage	3.7V
Continuous discharging time	>15h
Main light LED	
Working voltage	3.7V
Working current	0.3A
Luminous flux	>10 000 Lux
lamp lighting degree (distance 1 meter)	>10 000Lux (at the starting time) >10 000Lux (after 11 hours working time)
Main light Usage life hour	>50000h
Weight with battery	<500g
Charge protective voltage	4.2V
Discharge protective voltage	3.0V
Usage duration of battery (recharges)	>1000 recharges (in reasonable working condition)
Charging time	5 hours

Miner's Headlamp with Cord (ALK300)



Product #	Colour	Description
ALK300	Black	Miner's helmet lamp

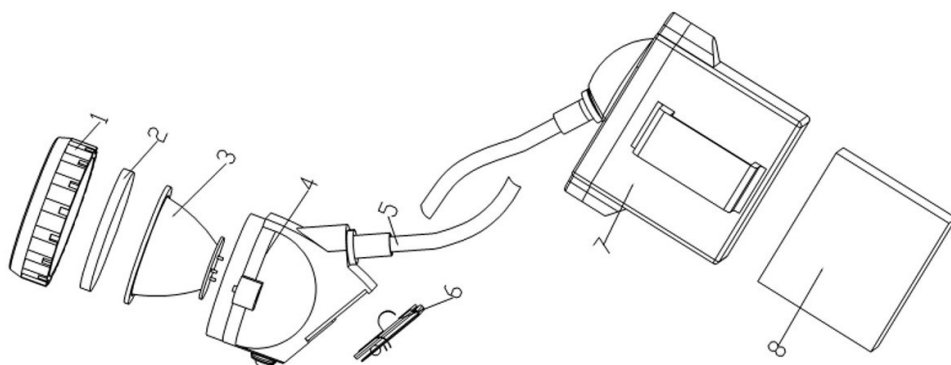

Replacement parts

# piece	Code #	Description
1	ALK306	Replacement bracket
2	ALK307	Replacement lens
3	ALK304	Replacement lightbulb 10000 Lux
4	ALK305	Replacement cover
5	ALK302	1.4-m power supply cord
6	ALK308	Replacement metal clip
7	ALK303	Battery case
8	ALK301	Replacement battery 6.5Ah Li-ion
	ALK309	AC110-230-volt replacement charger

Charger racks

Charger racks	Description
ALK350	Docking station for 60 miner's headlamps

